

Inspection Guide

At the beginning of the working day, be sure to check that there are none of the conditions marked with a X below. Snapping and unsnapping actions should not be too weak or too stiff.

Make sure the item is not turning and there is no damage or deformation.

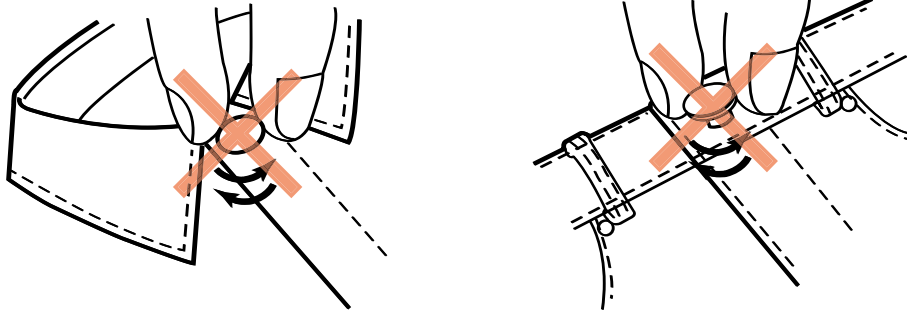

The item may turn around if the fabric is too thin. Packing is required in this case.

Make sure the item does not come off easily. Try to pluck it off with your fingertip or nail. Make checking for this your routine at the beginning of the working day.

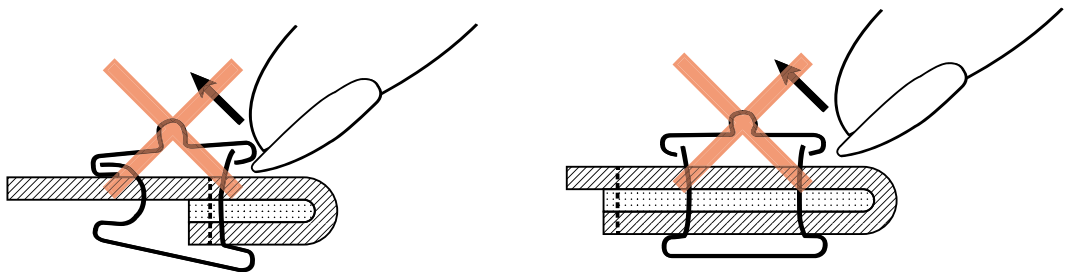

Make sure the fabric around the item is not torn. The item should not be attached on uneven thickness or over the stitching.

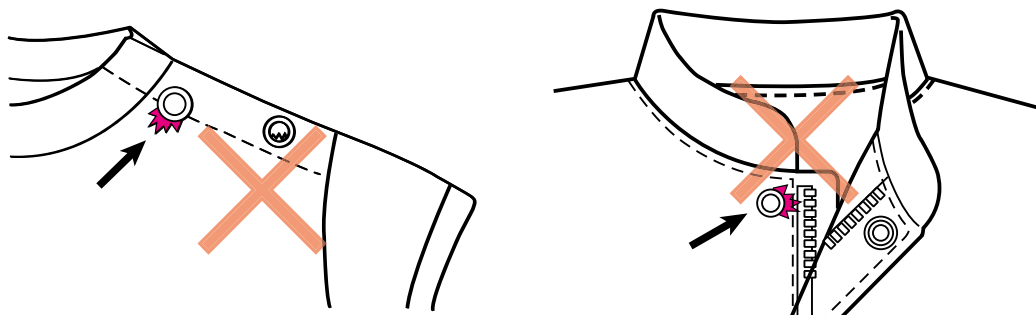

Attach inside the stitch line. Items over zipper tapes may cause fabric to tear.